

THETFORD

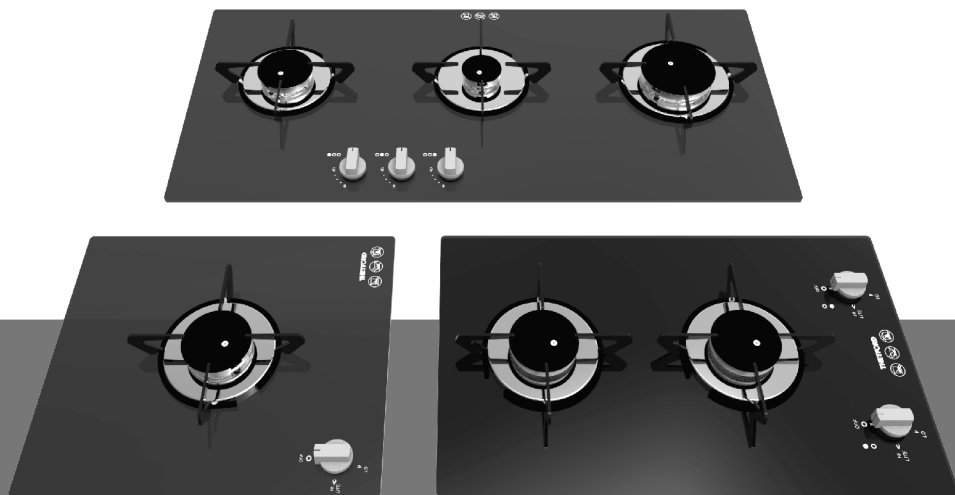

INSTALLATION MANUAL

HOB

Topline 900 series

EN

Original Installation Manual

Contents

1	Introduction.....	2
2	Safety.....	3
3	Serviceability.....	5
4	Technical specifications.....	6
5	Before installation.....	8
6	Installation.....	13
7	After installation.....	15
8	Service & questions.....	16

1. Introduction

General

This is the installation manual for the Thetford Topline SHB910, SHB922, SHB931 & SHB932 series hob. The manual is meant for qualified installers who will install the appliance in a caravan, camper or holiday home.

Read the information and instructions carefully and follow them strictly to install the appliance safely and correctly.

Also read the warnings in the user manual before testing the appliance after installation.

This document is version SINS2308/0125-V03 of the installation manual.

Our policy is one of continuous development and improvement. Specifications and illustrations may change subsequent to publication.

Please visit www.thetford.com for the most recent version.

Symbols

The following symbols may be used in this manual:



Warning. Risk of serious injury and/or damage.



Caution. Risk of moderate injury and/or damage.



Attention. Important information.



Note. Additional information.



Video. Additional instruction video available.

2. Safety



READ THESE INSTRUCTIONS FOR USE CAREFULLY . FAMILIARISE YOURSELF WITH THE APPLIANCE. KEEP THESE INSTRUCTIONS FOR FUTURE REFERENCE.

General



Risk of serious injury through burning, explosion, clamping, electrocution, suffocation and poisoning or damage to the product.

- The appliance is only meant for installation inside a caravan, camper or holiday home.
- If the appliance is not installed in accordance with national and European law, regulations, rules and standards, this will void the warranty and may lead to criminal prosecution.
- Do not modify this appliance, unless the modification is authorised and carried out by the manufacturer or their agent.
- Use only genuine and approved parts and materials.
- Wear the correct Personal Protective Equipment during installation. Also follow the applicable safety regulations.
- Gas and electrical appliances should only be installed by qualified and certified professionals.
- **DO NOT** block/suffocate ventilation for the appliance.

Installation



Risk of serious injury through burning, explosion, clamping, electrocution, suffocation and poisoning or damage to the product.

- This appliance may be installed in a kitchen/kitchen diner but not in a room containing a bath or a shower.
- LPG appliances must not be fitted below ground level e.g. in a basement.
- Follow the minimum dimensions shown in this manual. Any deviation could result in excessive temperature rise. If the minimum dimensions must be reduced, due to design constraints, a temperature rise test of all furniture fitted around the appliance must be performed. Where the minimum dimensions are reduced, it is recommended to install non-combustible material.

- The surrounding surfaces must be able to withstand the allowable temperature rise of 65°C above ambient temperature, as specified in the EN30-1-1 standard and in accordance with the design of this unit.
- The temperature of the surrounding surfaces may rise if there are other additional devices besides the appliance. Check the allowable temperature of the materials used for the surrounding surfaces to ensure that they meet the requirements of EN30-1-1, EN1949, EN1645-1, EN1646-1, EN1647 and EN721.
- All combustible materials such as curtains and shelves must be kept well clear of the appliance.
- To ensure correct operation the installation must allow for free exchange of air between the enclosure and the living environment.
- Design constraints may dictate additional venting at the front of the installation.
- This appliance must be earthed.
- Route cables away from the appliance and other heat sources.
- Do not allow cables to hang loose into the lower compartment.

Gas specific safety



Risk of serious injury through burning, explosion, clamping, electrocution, suffocation and poisoning or damage to the product.

- Ensure that the type of gas and pressure match the specification of the appliance. You can find the specification on the data badge.
- Prior to installation, ensure that the local distribution conditions (nature of the gas and gas pressure) and the adjustment of the appliance are compatible.
- This appliance is not connected to a combustion products evacuation device. It shall be installed and connected in accordance with current installation regulations. Particular attention shall be given to the relevant requirements regarding ventilation.
- Pay close attention to current regulations on ventilation in the country of use. The installation must provide for adequate air supply for combustion to the burners, safe removal of combustion products and avoidance of accumulation of unburned gases.
- The appliance must be positioned free from draughts, which may effect the combustion.
- Maintain provision for the dispersal of unburned gas beneath the appliance. Ensure any gas dispersal hole is located away from any burner.
- To ensure correct operation and prevent changes in air pressure affecting appliance performance, the appliance must be built into a securely fixed self-contained cabinet which is not connected to externally vented chambers in adjacent furniture, other than the gas dispersal hole described above.
- Use only metal gas pipes in accordance with the requirements of EN1949.
- NEVER use flexible/rubber tubing or hoses to connect gas.



It is recommended to install an over pressure shut off device (OPSO) downstream of the gas regulator. In case of a regulator failure the OPSO will immediately stop the gas flow.

12V DC specific safety



Risk of serious injury through burning, explosion, clamping, electrocution, suffocation and poisoning or damage to the product.

- Ensure the installation and materials used are in accordance with the latest legislation and regulations on electrical installations in the country of use.
- Observe polarity to prevent damage to the appliance and/or damage to other appliances connected to the 12V DC circuit:
 - +12V DC or positive wire is colored red.
 - -12V DC or negative or ground wire, is colored black or white.

3. Serviceability

The installer of Thetford products is responsible for correct installation according to the Thetford installation instructions to ensure the functionality and serviceability of the product.







In terms of serviceability, this means that a dealer or authorised Thetford service partner must be able to remove and re-install the Thetford product within the time that is allowed according to the Thetford time-list, using standard tools and equipment.

This is to claim any warranty during the warranty period after the purchase date.

In case of any queries on this subject, a Thetford local service representative can be contacted for additional support related to the installation of the product.

4. Technical specifications

Table 1: Burner specifications

	SHB910			SHB922		
	Gas input		Injector	Gas input		Injector
						
	kW	g/hr	mm	kW	g/hr	mm
Gas burners	1.51	109	0.61	2 x 1.48	2 x 107	0.61
Total	1.51	109		2.96	213	
Electrical supply	12V DC			12V DC		







	SHB931			SHB932		
	Gas input		Injector	Gas input		Injector
						
	kW	kW	mm	kW	g/hr	mm
Gas burners	1 x 2.28 1 x 1.42 1 x 0.96	1 x 164 1 x 102 1 x 69	0.77 0.61 0.52	2 x 1.49 1 x 0.96	2 x 107 1 x 69	0.61 0.52
Total	4.66	336		3.94	284	
Electrical supply	12V DC			12V DC		

Table 2: Dimensions and weight

	SHB910			SHB922		
Dimensions	H	W	D	H	W	D
mm	113 ¹ / 75 ²	355	305	112 ¹ / 75 ²	500	305
Appliance weight	5.5kg			5.5kg		

	SHB931			SHB932		
Dimensions	H	W	D	H	W	D
mm	132 ¹ / 95 ²	770	350	113 ¹ / 75 ²	544	314
Appliance weight	7kg			5kg		

1. Total height including top of pan rest to threaded bolt below.
2. Height from surface to threaded bolt below.



This appliance is suitable for use with LPG [Liquefied Petroleum Gas] and should not be used with any other gas.

Table 3: Gas category

Class 3 Appliance		
Gas category & Pressure	CAT I ₃ + (28-30/37)	CAT I ₃ B/P (30)
	BUTANE (G30) 28 – 30mbar	BUTANE (G30) 30mbar
	PROPANE (G31) 37mbar	PROPANE (G31) 30mbar
For installation in	BE, CH, CY, CZ, ES, FR, GB, GR, IE, IT, LT, PT, SI, TR	AT, BE*, CH, CY, CZ, DE, DK, EE, FI, FR, GB*, GR, HR, HU, IT, LT, NL, NO, PL, RO, SE, SI, SK, TR
Normative references	EN 30-1-1 : 2021 EN 30-2-1 : 2015	

(*) Category applicable only for appliances installed in Touring & Motoring Caravans.



Use only the type of gas and the pressures specified. The specifications for your appliance can be found on the label described in chapter *Service & questions*.

5. Before installation

Content of the box

For the single-piece packaged appliance, check the content:

- Appliance
- Template
- Threaded studs and nuts (4x)
- Washer and wing nuts (4x)
- User manual
- Installation manual



If something is missing, please contact your dealer.

Cabinet requirements

The location must provide:

- Wood cabinetry and worktop
- Support for at least the weight of the appliance as stated in Technical specifications plus any items placed on top.



The total weight placed on top of the hob should not exceed 10kg.

- Minimum installation clearances for installation location and gas dispersal, as stated in Installation dimensions.

Cabinetry protection dimensions



The distances below are between the edge of the burners and the sides and between the pan rests and overhanging parts.

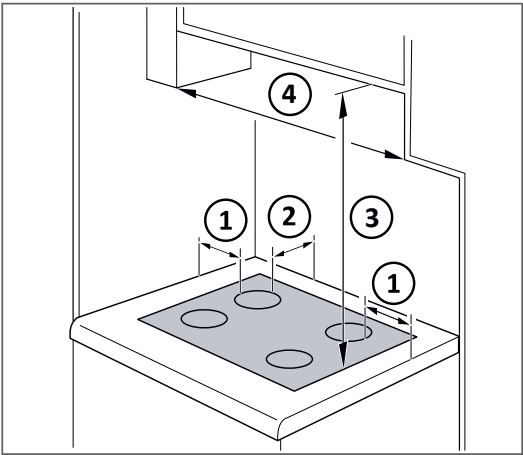

Caution: the surface temperature exceeds 95°C. To avoid a hazard, under bench access must be restricted.



If you are unable to maintain the minimum distances mentioned in the table below, protect with non-flammable material.

Table 4: Cabinetry protection dimensions

Model / Dimension (mm)	①	②	③	④
SHB910	200	200	500	355
SHB922	200	200	500	500
SHB931	200	200	500	770
SHB932	200	200	500	544

Cabinetry ventilation and protection dimensions



Maintain provision for the dispersal of unburnt gas beneath the appliance. Ensure any gas drop hole is located away from the burners. The gas drop hole must vent to the outside of the leisure vehicle.

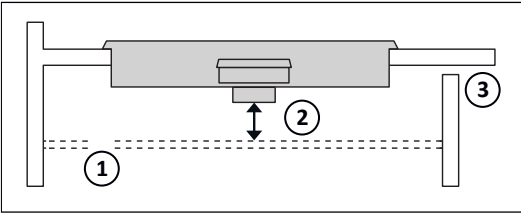

- 1. Gas drop hole
- 2. Distance to non-combustible material from the lowest point of the hob (e.g. gas pipework, gas taps, spark generator etc.
- 3. Front ventilation gap

Make sure the installation is according to the following, referring to the distances indicated in the next table: *Ventilation & protection dimensions*

- Apply a minimum distance ② from the lowest point of the Hob, in all scenarios. And where the underneath of the Hob is exposed, then a non-combustible heat shield at point 2 is mandatory.
- Create a gas drop hole ①, which must vent to the outside of the leisure vehicle.
- It is strongly recommended to cut a slot in the cabinet under the front of the worktop ③, to dissipate heat from under the appliance.

Table 5: Ventilation and protection dimensions

① in mm	② in mm	③ in mm
25 - 50	30	8 x 100



To ensure correct operation and prevent changes in air pressure affecting appliance performance, the appliance must be built into a securely fixed self-contained cabinet which is not connected to externally vented chambers in adjacent furniture, other than the gas drop hole described above.



Protect the underside of the appliance with a heat shield made from non-combustible material, if the space below the hob is used for storage or another appliance.

Installation dimensions

- Place the template on the worktop.
- Prepare the cut-out as shown.
- Drill the holes with an electric drill with a 10mm drill bit.

Prepare the SHB910 worktop cut-out:

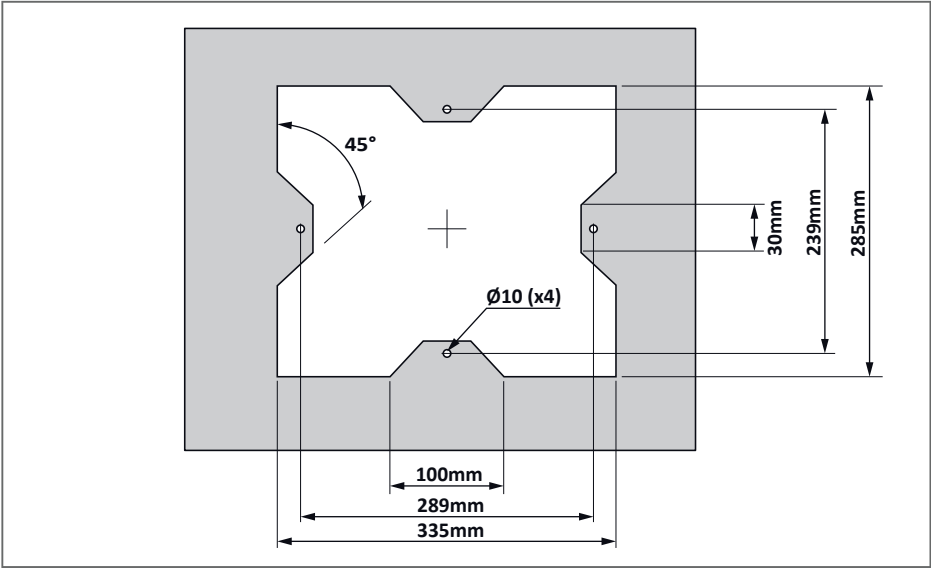

Prepare the SHB922 worktop cut-out:

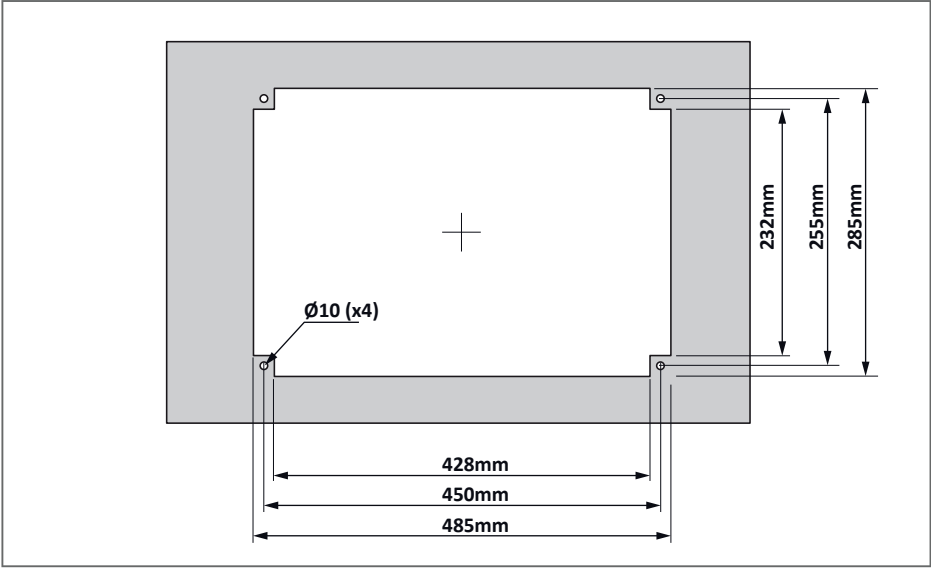

Prepare the SHB931 worktop cut-out:

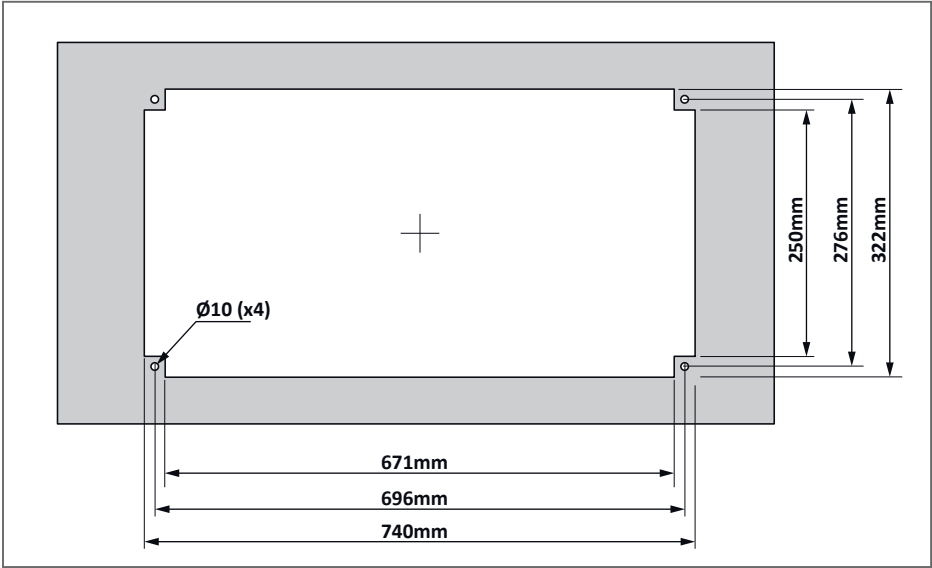

Prepare the SHB932 worktop cut-out:

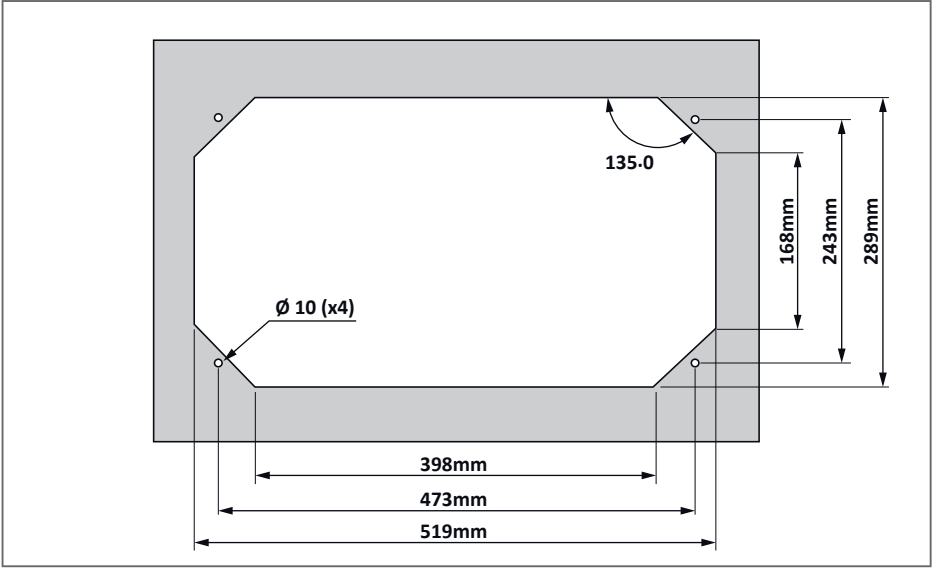

Schematic overview of surface mounting the appliance into the cabinet

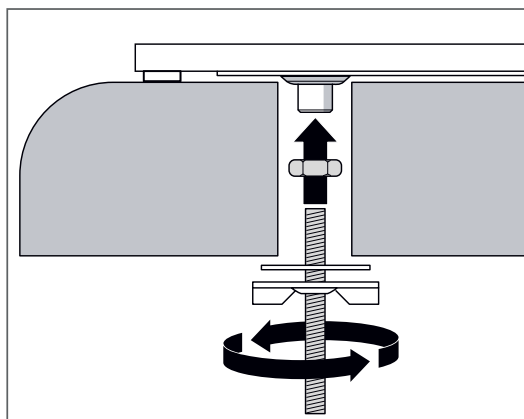

1. Locate the threaded studs and nuts (x4).
2. Position the nut on the stud at 4mm from the top.
3. Screw the stud into the threaded fixing on the underside of hob.
4. Lock the nut against the threaded fixing using a spanner. Do not over-tighten.
5. Position the unit so it is centred and level in the cut-out.
6. There must also be a gap of 2-3mm between the appliance and sides of the cut-out.
7. Attach the washer and wing nut to the stud.

6. Installation



Read the applicable instructions in chapter *Safety* first.

Prepare



See *Technical specifications* and *Before installation* for more information.

- Prepare the cabinet and worktop for the appliance.
- Ensure the air gaps are according to specifications.
- Ensure the gas dispersion hole has the correct size and is not blocked.

Install the appliance

- Remove all packaging materials from the appliance.
- Slide the appliance half way into the opening.
- Connect the 12V DC cables for spark ignition (and cooling fans where applicable) to a 12V DC battery or power supply, using suitable connectors and observing the correct polarity.



Black/Schwarz/Noir		Verify supply polarity before connecting Warranty void if connection reversed.
Red/Rot/Rouge		

- Place the appliance into the opening.
- Fix the appliance in place using the fastener positions as shown in chapter '*Before installation*'.



Make sure the appliance is located correctly in the aperture.



Check the position of the Hob in the worktop and perimeter seal before tightening the fasteners.

Connect the gas supply

- Connect the gas pipe to the Ø 8mm gas inlet of the appliance.

Attach labels

- Attach a warning label next to the unit that meets the requirements of EN721, Annex A.
- Attach a warning notice next to the gas dispersal hole, with the text: Warning! Under no circumstances should the gas dispersion hole be obstructed.

7. After installation



Read the applicable instructions in chapter *Safety* first.

Visual checks

Check if:

- All packaging materials have been removed.
- The appliance is placed, mounted and levelled on a stable structure.
- Vents and gas dispersal hole are not blocked/obstructed.
- Electrical cables are not pinched, damaged or hanging loose.
- Electrical cables are not routed close to heat sources (such as hob, oven or heater) and ignition sources.
- Electrical connectors are seated correctly.

Functional checks

Check if:

- All gas piping and connections are correct and do not leak.
- Appliance can operate only on gas and pressures as shown in table 3 of the *Technical specifications*.
- Appliance can be switched on/off and the temperature is adjustable.
- The flames have a proper colour. The burners have a fixed air/fuel mixture. When using propane, the flames burn quietly with a blue-green colour and no yellow at the tip. With butane, the flames have yellow tips. The yellow colour of the flames increases slightly as the burner heats up.
- The pressure of the gas when all connected gas appliances are in use simultaneously. The gas pressure may not rise or fall by more than 2.5mbar relative to the nominal value.

8. Service & questions



Read the applicable instructions in chapter *Safety* first.

Service

Before any service work is started, the appliance should have been left to cool and be disconnected from both the gas and electrical supplies. After each service the appliance must be checked for gas soundness and electrical safety.



All servicing must be carried out by an approved competent person.

Questions

If you have questions about your product, parts, accessories or authorised services visit www.thetford.com.

If you contact an authorised local Service Centre in your country, provide the details of the model and serial number plus the date of purchase.

Model		THETFORD
<h1>SPECIMEN</h1>		
Serial Number	Item Number	

Warranty

For our warranty clause, please refer to the conditions mentioned on www.thetford.com.

Declaration of Conformity

Thetford hereby declares that this product is in compliance with the essential requirements and other relevant provisions of the applicable Regulations, Directives and Standards. A copy of the Declaration of Conformity can be found at www.thetford.com.

EUROPEAN HEADQUARTERS

Thetford B.V.
P.O. Box 169
4870 AD Etten-Leur
The Netherlands

T +31 76 504 22 00
F +31 76 504 23 00
E info@thetford.eu

UNITED KINGDOM

Thetford Ltd.
Unit 6
Brookfields Way
Manvers, Rotherham
S63 5DL, England
United Kingdom

T +44 844 997 1960
F +44 844 997 1961
E info@thetford.eu

GERMANY

Thetford GmbH
Schallbruch 14
D-42781 Haan
Deutschland

T +49 2129 94250
F +49 2129 942525
E info@thetford.eu

FRANCE

Thetford S.A.R.L.
Parc BUROPLUS / Bâtiment 6
18, Boulevard de la Paix
CS 80008
95895 Cergy Pontoise Cedex
France

T +33 1 30 37 58 23
F not available
E info@thetford.eu

ITALY

Thetford Italy c/o Tecma s.r.l.
Via Flaminia
Loc. Castel delle Formiche
05030 Otricoli (TR)
Italia

T +39 0744 709071
F +39 0744 719833
E info@thetford.eu

SPAIN AND PORTUGAL

Mercè Grau Solà
Agente para España y Portugal
C/ Castellet, 36 bxs 2a
08800-Vilanova i la Geltrú
Barcelona
España

T +34 938 154 389
F not available
E info@thetford.eu

SCANDINAVIA

Thetford Scandinavia
Bangatan 6
521 43 Falköping
Sverige

T +46 31 336 35 80
F not available
E info@thetford.eu

AUSTRALIA

Thetford Australia Pty. Ltd.
130-132 Freight Drive
Somerton VIC 3062
Australia

T +61 3 9358 0700
F not available
E info@thetford.com.au
www.thetford.com.au

CHINA

Thetford China
Rm. 1207, Coastal Building
(East Block)
Haide 3rd Road, Nanshan District
Shenzhen, 518054
China

T +86 755 8627 1393
F +86 755 8627 1673
E info@thetford.cn
www.thetford.cn